

# » H2 hard shoulder

## H2BL1300

### components

- 2W Beam 5333 mm th. 3,0 mm;
- "C" Section Post 30x80x120 mm th. 4,0 mm  
H = 1680 mm c/c 1777,6 mm;
- Connection Element (Beam/Post);
- Stiffner for "C" Post;
- Unthreading proof little plate;
- Bolts and Nuts;
- Reflector (n° 1 every 10,66 m).

This Barrier provides, for each section of barrier, the installation of mitred Approach/Escape modules for a total length of 19,046 m (9,523 for Approach+ 9,523 for Escape).

### section

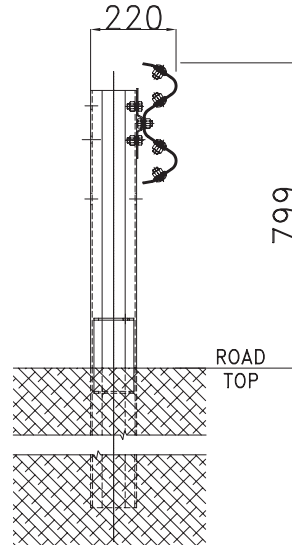

- Dwg. n.: H2BL1300  
c/c distance between the posts: 1.777 mm

### performance

TB11 - Car 900 kg  
Test: 1279  
ASI: A - 0,80

TB51 - Bus 13.000 kg  
Test: 1278  
W<sub>N</sub>: m 1,3 (W4)  
D<sub>N</sub>: m 1,2  
V<sub>N</sub>: m 2,0 (VI6)

# FRONT VIEW

mm 83045,6

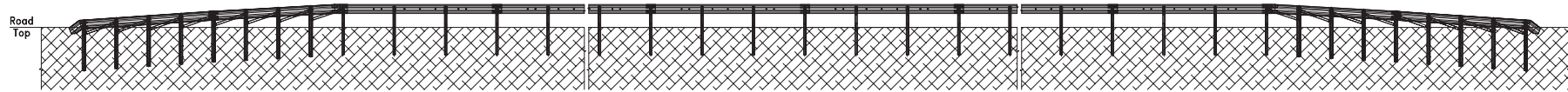
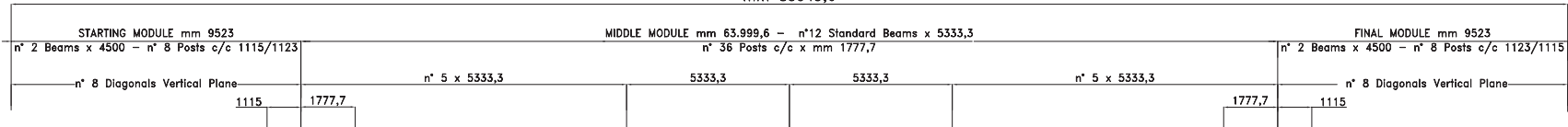

TRAFFIC DIRECTION (Impact on the Left) →

# TOP VIEW

