

# » H2 hard shoulder

## H2BL1500\_Gutter

### components

- 3W Beam 5333 mm th. 2,5 mm
- "C" Section Post 30x80x120 mm th. 5,0 mm  
H = 1750 mm c/c 2133,3 mm;
- Connection Element (Beam/Post)
- Stiffener for "C" Post;
- Unthreading proof little plate
- Bolts and nuts
- Reflectors (1 every 16 lm)

### section

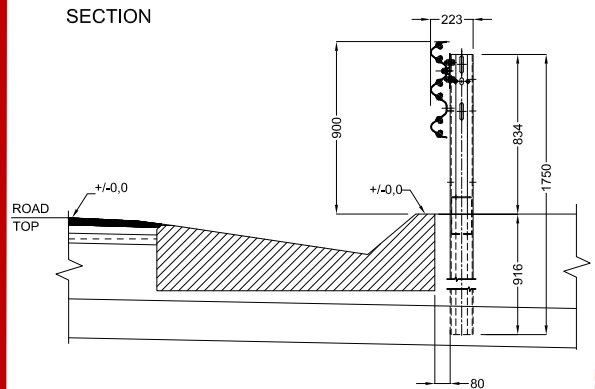

- Dwg. n.: H2BL1500\_Can  
c/c distance between posts: 2133 mm

### performance

TB11 – Car 900 kg  
Test: IME 1795  
ASl: A - 0,80

TB32 – Car 1500 kg  
Test: IME 1796  
ASl: A - 0,70

TB51 - Bus 13.000 kg  
Test: IME 1793  
W<sub>N</sub>: m 1,0 (W3)  
D<sub>N</sub>: m 0,9  
V<sub>N</sub>: m 1,3 (VI4)

# FRONTAL VIEW

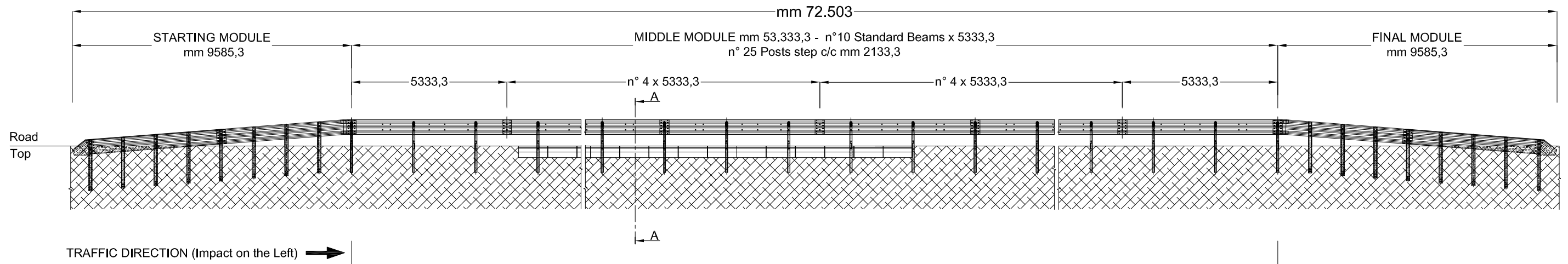

# TOP VIEW

